

### SRP20A Power Pallet Truck

- Medium to long distance horizontal transport.
- Lorry loading and unloading.
- With Foldable Standard platform.

#### Advantages:

- All travel, lift/lower and safety controls grouped on the tiller, easy to operate.
- Digital Control (DC) provides precise controls.
- Two Speed Option with two operation system.
- Two lift cylinders and one extra central cylinder, ensure stable operation
- Ergonomic operating handle and controls
- Automatic braking increase safety.
- Designed for servicing convenience.
- little effort, low cost.

#### Features and Options:

- Special option for entry and exist rollers.
- Double pallet long forks option.
- Comfortable rider platform.
- Big size is available.
- Single or double load wheel option.

### SRP20A

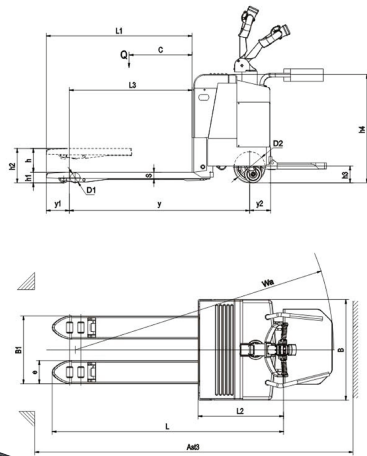

Ergonomics operating handle and controls



Comfortable rider platform big size is available



### SRP20E Power Pallet Truck (2000kg or 2500kg)

- Medium to long distance horizontal transport.
- Lorry loading and unloading.
- With unfoldable Standard platform.

#### Advantages:

- All travel, lift/lower and safety controls grouped on the tiller, easy to operate.
- Digital Control (DC) provides precise controls.
- Two Speed Option with two operation system.
- Two lift cylinders and one extra central cylinder, ensure stable operation.
- Ergonomic operating handle and controls
- Automatic braking increase safety.
- Designed for servicing convenience.

#### Options:

- Special option for entry and exist rollers.
- Double pallet long forks option.
- Comfortable rider platform.
- Big size is available.
- Single or double load wheel option.

### SRP20E

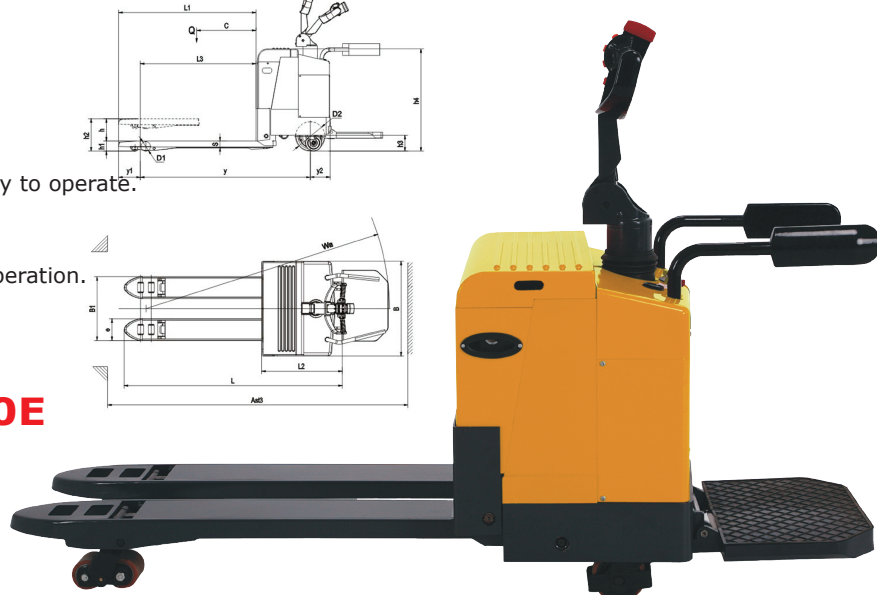
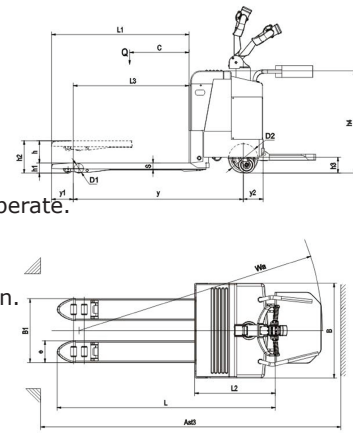

Safety handle protect the poperator on high speed



Auto-folding platform Easy charger plug



Two speed option on operation handle

model			SRP20A		SRP20A	
characteristics	capacity		kg	2000	lbs.	4500
	load centre		mm	600	inch	24"
	operator type			rider		rider
dimensions	H	lifting height	mm	120	inch	4.7"
	H1	ground fork width	mm	85	inch	3.3"
	H2	raised height	mm	205	inch	8"
	B1	standard fork width	mm	540/685	inch	21"/27"
	L1	fork length	mm	1150/1200	inch	45"/48"
	S	fork thickness	mm	55	inch	2.3"
	e	fork width	mm	185	inch	7.3"
	L	overall length	mm	2077/2177	inch	81.7"/85.7"
	H3	height of rider platform	mm	240	inch	9.4"
	H4	rear height	mm	870	inch	34"
	L2	rear length	mm	927	inch	36.5"
	B	overall width	mm	802	inch	31.6"
	Wa	minimum turning radius	mm	1872/1922	inch	73.7"/75.7"
	ast3	aislewidth(800*1200mm pallet):horizontal/vertical	mm	1630/2245	inch	64"/88"
	ast3	aislewidth(1000*1200mm pallet):horizontal/vertical	mm	1838/2245	inch	72"/88"
	Max. battery size(L*W*H)		mm	608x274x480	inch	24"x10.8"x18.8"
performance	Max. travel speed		km/h	5 and 8/8 and 12	mph	3.15 and 5/5 and 7.56
	(double speed): laden/unladen			(open the rabbit switch)		(open the rabbit switch)
	Max. lifting speed: laden/unladen		m/s	0.056/0.06	inch/s	2
	Max. lowering speed: laden/unladen		m/s	0.057/0.059	inch/s	2
	gradeability: laden/unladen		%	5/7	%	5/7
	service weight without battery		kg	535	lbs.	1180
weight	service weight with battery		kg	742	lbs.	1630
	wheel(drive/load)			Polyurethane/polyurethane		Polyurethane/polyurethane
wheel	wheel quantity		mm	1D+4L/1D+2L	inch	1D+4L/1D+2L
	D2	size of steering wheel	mm	Ø182x75	inch	Ø 9.8"x2.5"
	D1	size of load wheel	mm	Ø80x120(single wheel)	inch	Ø3.2"x4.8"(single wheel)
			mm	Ø80x80(single wheel)	inch	Ø3.2"x3.2"(double wheel)
		size of balance wheel	mm	Ø138*68	inch	Ø5.4"x2.7"
		wheel base	mm	467	inch	18.4
driving system	travelling motor		kw	2.2	HP	3
	lifting motor		kw	2	HP	2.7
	voltage/capacity/battery type		v/Ah	24v/210Ah/industry	v/ah	24v/210Ah/industry
	travelling barke			regenerate		regenerate
	barke			electromagnetic		electromagnetic
control	control system (transistor,stepless)			curtis 1243		curtis 1243

Remar 1, Performance may vary due to motor and system efficiency toolerance and represents nominal values under typical operating conditions.

model			SRP20E		SRP20E	
characteristics	capacity		kg	2000	lbs.	4500
	load centre		mm	600	inch	24"
	operator type			rider		rider
dimensions	H	lifting height	mm	120	inch	4.7"
	H1	ground fork width	mm	85	inch	3.3"
	H2	raised height	mm	205	inch	8"
	B1	standard fork width	mm	540/685	inch	21"/27"
	L1	fork length	mm	1150/1200	inch	45"/48"
	S	fork thickness	mm	55	inch	2.3"
	e	fork width	mm	185	inch	7.3"
	L	overall length	mm	2210/2260(folded)	inch	87"/89"
	H3	height of rider platform	mm	145	inch	9.4"
	H4	rear height	mm	870	inch	34"
	L2	rear length	mm	710	inch	28"
	B	overall width	mm	802	inch	31.6"
	Wa	minimum turning radius	mm	1655/1705(folded)	inch	65"/67"
	ast3	aislewidth(800*1200mm pallet):horizontal/vertical	mm	1636/2563	inch	64"/101"
	ast3	aislewidth(1000*1200mm pallet):horizontal/vertical	mm	1836/2563	inch	72"/101"
	Max. battery size(L*W*H)		mm	608x274x480	inch	24"x10.8"x18.8"
performance	Max. travel speed		km/h	5 and 8/8 and 12	mph	3.15 and 5/5 and 7.56
	(double speed): laden/unladen			(open the rabbit switch)		(open the rabbit switch)
	Max. lifting speed: laden/unladen		m/s	0.056/0.06	inch/s	2
	Max. lowering speed: laden/unladen		m/s	0.057/0.059	inch/s	2
	gradeability: laden/ unladen		%	5/7	%	5/7
	service weight without battery		kg	543	lbs.	1190
weight	service weight with battery		kg	750	lbs.	1650
	wheel(drive/load)			Polyurethane/polyurethane		Polyurethane/polyurethane
wheel	wheel quantity		mm	1D+4L/1D+2L	inch	1D+4L/1D+2L
	D2	size of steering wheel	mm	Ø248x65	inch	Ø9.8"x2.5"
	D1	size of load wheel	mm	Ø80x120(single wheel)	inch	Ø3.2"x4.8"(single wheel)
			mm	Ø80x80(single wheel)	inch	Ø3.2"x3.2"(double wheel)
		size of balance wheel	mm	Ø138*68	inch	Ø5.4"x2.7"
		wheel base	mm	250	inch	98"
driving system	travelling motor		kw	2.2	HP	3
	lifting motor		kw	2	HP	2.7
	voltage/capacity/battery type		v/Ah	24v/210Ah/industry	v/ah	24v/210Ah/industry
	travelling barke			regenerate		regenerate
	barke			electromagnetic		electromagnetic
control	control system (transistor,stepless)			curtis 1243		curtis 1243

Remark 1,Performance may vary due to motor and system efficiency toolerance and represents nominal values under typical operating conditions.



SWP/SRP Series

Power Pallet Truck

ISO9001  
CE



- Rated capacity: 1300kg/2000kg/2500kg.
- Robust workhorse for the toughest of applications
- Latest ergonomic design
- Available with a selection of forks width and length

DC

or

AC



SINOLIFT MATERIAL HANDLING EQUIPMENT CORP.

ADD: 618 Xile Road, Nanhui, Shanghai, China 201300

TEL: +86 21 68014500 /+86 21 58003681

FAX: +86 21 68014262 /+86 21 68038190

EMAIL: [info@sinolift.com](mailto:info@sinolift.com)

WEB: [www.sinolift.com](http://www.sinolift.com)







SWP13 Power Pallet Truck

Applications: Grocery, Light manufacturing and delievery trucks.

Features & Options:

- Power propelled, power lift truck are the logical step-up from manual trucks, as they out perform two to three operators with manual jacks.
- 24V DC high torque drive.
- Separately excited transistor controls.
- Two 12-volt maintenance free batteries standard.
- Optional portable charger available.
- Very Small Turning Radius, Smart in narrow aisle and inside elevator/container.
- Single & Double load wheel is optional.

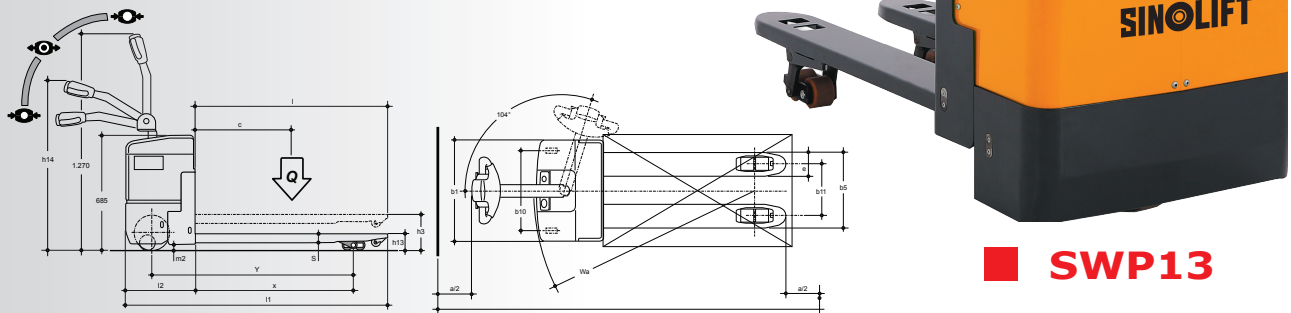

SWP13



Inner charger option



Single or double load wheel option

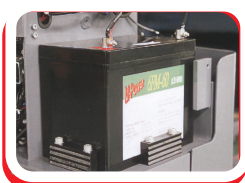

Maintenance free battery



Creep switch option

model	SWP13	SWP13
characteristics	capacity	kg
	load centre	mm
	operator type	Walkie
	operator type	Walkie
dimensions	H	lifting height
	H1	Ground clearance+fork thickness
	H2	raised height
	B1	standard fork width
	L1	fork length
	S	fork thickness
	e	fork width
	L	overall length
		rear length
	B	overall width
	Wa	minimum turning radius
	ast3	aislewidth(800*1200mm pallet):horizontal/vertical
	ast3	aislewidth(1000*1200mm pallet):horizontal/vertical
	ast3	aislewidth(1000*1200mm pallet):horizontal/vertical
performance	maximum travel speed:laden/unladen	km/h
	maximum lifting speed: laden/unladen	m/s
	maximum lowering speed: laden/unladen	m/s
	gradeability: laden/unladen	%
	gradeability: laden/unladen	%
weight	service weight without battery	kg
	service weight with battery	kg
wheel	wheel(drive/load)	poly/poly
	wheel quantity	1D+4L/1D+2L
	D1	size of steering wheel
	D2	size of load wheel
		size of balance wheel
driving system	travelling motor	kw
	lifting motor	kw
	voltage/capacity/battery type	v/Ah
	travelling barke	regenerate
	barke	electromagnetic
control	control system (transistor,stepless)	curtis 1243

Remark: 1, Performance may vary due to motor and system efficiency tolerance and represents nominal values under typical operating conditions.

SWP20A Power Pallet Truck

Quality, durability and efficient pallet management for medium duty applications.

Features & Options:

- Separately excited transistor controls.
- Battery pack w/built-in charger available.
- Long life reaction system, The traction unit is mounted centrally, special stronger gear box makes long life. of separately excited motor. It's external position ensures adequate ventilation.
- Standard grease fitting on pivot points.
- Driving performance can be adjusted by program unit.
- Special in-line caster option for rough ground.

CURTIS Control System  
Driving performance can  
beadjusted by programme unit

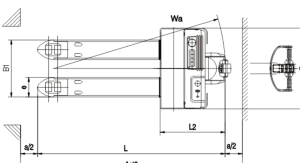
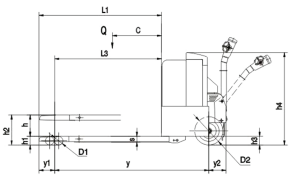

Traction motor mounted design,  
ensures adequate ventilation.  
Rubber driving wheel

SWP20A

model	SWP20A	SWP20A
characteristics	capacity	kg
	load centre	mm
	operator type	Walkie
	operator type	Walkie
dimensions	H	lifting height
	H1	ground fork width
	H2	raised height
	B1	standard fork width
	L1	fork length
	S	fork thickness
	e	fork width
	L	overall length
		rear length
	B	overall width
	Wa	minimum turning radius
	ast3	aislewidth(800*1200mm pallet):horizontal/vertical
	ast3	aislewidth(1000*1200mm pallet):horizontal/vertical
	ast3	aislewidth(1000*1200mm pallet):horizontal/vertical
performance	maximum travel speed:laden/unladen	km/h
	maximum lifting speed: laden/unladen	m/s
	maximum lowering speed: laden/unladen	m/s
	gradeability: laden/unladen	%
	gradeability: laden/unladen	%
weight	service weight without battery	kg
	service weight with battery	kg
wheel	wheel(drive/load)	rubber/poly
	D2	size of steering wheel
	D1	size of steering wheel
		size of load wheel
	y	wheel base
driving system	travelling motor	kw
	lifting motor	kw
	voltage/capacity/battery type	v/Ah
	travelling barke	regenerate
	barke	electromagnetic
control	control system (transistor,stepless)	Curtis 1243

Remark: 1,Performance may vary due to motor and system efficiency tolerance and represents nominal values under typical operating conditions.

SWP20E Power Pallet Truck

Compact, low cost, powered pallet truck designed for horizontal pallet movement in light to medium duty applications.

Features & Options:

- Light enough to be used on mezzanine floors and vehicle tail lifts.
- High mobility in confined spaces due to its compact size.
- Easy pallet entry.
- Rechargeable from any wall socket.
- Minimum maintenance costs.
- High quality components.
- Easy accessibility of serviceable parts.
- Grease nipples on all moving components.

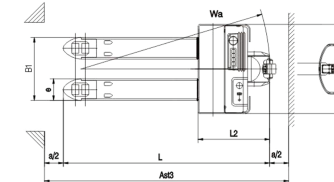
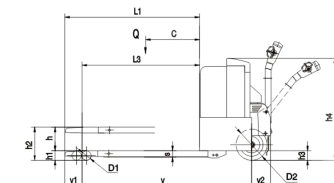

Strong and reliable forks  
Easy entry rollers design



Erect traction motor design,  
easy maintenance.  
Poly driving wheel

SWP20E

model	SWP20E	SWP20E
characteristics	capacity	kg
	load centre	mm
	operator type	Walkie
	operator type	Walkie
dimensions	H	lifting height
	H1	ground fork width
	H2	raised height
	B1	standard fork width
	L1	fork length
	S	fork thickness
	e	fork width
	L	overall length
		rear length
	B	overall width
	Wa	minimum turning radius
	ast3	aislewidth(800*1200mm pallet):horizontal/vertical
	ast3	aislewidth(1000*1200mm pallet):horizontal/vertical
	ast3	aislewidth(1000*1200mm pallet):horizontal/vertical
performance	maximum travel speed: laden/unladen	km/h
	maximum lifting speed: laden/unladen	m/s
	maximum lowering speed: laden/unladen	m/s
	gradeability: laden/unladen	%
	gradeability: laden/unladen	%
weight	service weight without battery	kg
	service weight with battery	kg
wheel	wheel(drive/load)	poly/poly
	wheel quantity	1D+4L/1D+2L
	D2	size of steering wheel
	D1	size of load wheel
	y	wheel base
driving system	travelling motor	kw
	lifting motor	kw
	voltage/capacity/battery type	v/Ah
	travelling barke	regenerate
	barke	electromagnetic
Control	control system (transistor,stepless)	curtis 1243

Remark: 1,Performance may vary due to motor and system efficiency tolerance and represents nominal values under typical operating conditions.